

AGENDA OF THE REGULAR MEETING OF THE ALCOHOL, GAMBLING & TOBACCO COMMISSION

August 5, 2015

The regular meeting of the Alcohol, Gambling & Tobacco Commission will be held on Wednesday, August 5, 2015, at 4:45 p.m., in the City Council Chambers, 3rd Floor, City Hall.

ROLL CALL: Dennis Birchland, Bjorn Braaten, Bryn Pollard, Jeff Rosenthal,
Chris Pekkala, Adam Wisocki, President Stauber

***ANYONE WHO HAS BUSINESS BEFORE THIS
BOARD SHOULD MAKE PLANS TO ATTEND***

COMMUNICATIONS:

LAWFUL GAMBLING:

ALS

raffle exemption – 60 day waiver

NEW BUSINESS:

DULUTH SUPERIOR GLBTAQI PRIDE (DULUTH SUPERIOR PRIDE FESTIVAL) BAYFRONT PARK – APPLICATION FOR TEMPORARY ON-SALE INTOXICATING LIQUOR LICENSE FOR SEPTEMBER 5, 2015, WITH CAROLN REISBERG, MANAGER.

KENRITE, INC. (BULLDOG PIZZA & GRILL), 101 MT ROYAL CENTER – APPLICATION FOR TEMPORARY EXPANSION OF THE ON SALE WINE AND 3.2 PERCENT MALT LIQUOR LICENSE FOR OCTOBER 10, 2015.

RENEWAL APPLICATIONS OF THE ON SALE INTOXICATING LIQUOR LICENSES, ON SALE SUNDAY LICENSES, ON SALE DANCING LICENSES, ADDITIONAL BAR LICENSES, AND 2:00 A.M. LICENSES, FOR THE PERIOD BEGINNING SEPTEMBER 1, 2015, AND ENDING AUGUST 31, 2016.

RENEWAL APPLICATIONS OF THE ON SALE WINE LICENSES FOR THE PERIOD BEGINNING SEPTEMBER 1, 2015, AND ENDING AUGUST 31, 2016.

RENEWAL APPLICATIONS OF THE OFF SALE INTOXICATING LIQUOR LICENSES FOR THE PERIOD BEGINNING SEPTEMBER 1, 2015, AND ENDING AUGUST 31, 2016.

RENEWAL APPLICATIONS OF THE ON SALE "CLUB" LIQUOR LICENSES FOR THE PERIOD BEGINNING SEPTEMBER 1, 2015, AND ENDING AUGUST 31, 2016.

RENEWAL APPLICATION OF THE BREWERY MALT LIQUOR ON AND OFF SALE INTOXICATING LIQUOR LICENSES FOR THE PERIOD BEGINNING SEPTEMBER 1, 2015, AND ENDING AUGUST 31, 2016.

RENEWAL APPLICATION OF THE MICRO DISTILLERY ON AND OFF SALE INTOXICATING LIQUOR LICENSES FOR THE PERIOD BEGINNING SEPTEMBER 1, 2015, AND ENDING AUGUST 31, 2016.

MINNESOTA LAWFUL GAMBLING
LG220 Application for Exempt Permit

An exempt permit may be issued to a nonprofit organization that:

- conducts lawful gambling on five or fewer days, and
- awards less than \$50,000 in prizes during a calendar year.

If total raffle prize value for the calendar year will be \$1,500 or less, contact the Licensing Specialist assigned to your county by calling 651-539-1900.

Application Fee (non-refundable)

Applications are processed in the order received. If the application is postmarked or received 30 days or more before the event, the application fee is **\$100**; otherwise the fee is **\$150**.
Due to the high volume of exempt applications, payment of additional fees prior to 30 days before your event will not expedite service, nor are telephone requests for expedited service accepted.

ORGANIZATION INFORMATION

Organization Name: The ALS Association Previous Gambling Permit Number: X-04770
Minnesota Tax ID Number, if any: _____ Federal Employer ID Number (FEIN), if any: 41-1756085
Mailing Address: 333 N Washington Ave, Suite 105
City: Minneapolis State: MN Zip: 55401 County: Hennepin
Name of Chief Executive Officer (CEO): Jennifer Hjelle
Daytime Phone: 612-672-0484 Email: jenniferhjelle@dalsmn.org

NONPROFIT STATUS

Type of Nonprofit Organization (check one):
 Fraternal Religious Veterans Other Nonprofit Organization

Attach a copy of one of the following showing proof of nonprofit status:

(DO NOT attach a sales tax exempt status or federal employer ID number, as they are not proof of nonprofit status.)

- A current calendar year Certificate of Good Standing**
Don't have a copy? Obtain this certificate from:
MN Secretary of State, Business Services Division Secretary of State website, phone numbers:
60 Empire Drive, Suite 100 www.sos.state.mn.us
St. Paul, MN 55103 651-296-2803, or toll free 1-877-551-6767
- IRS income tax exemption (501(c)) letter in your organization's name**
Don't have a copy? To obtain a copy of your federal income tax exempt letter, have an organization officer contact the IRS toll free at 1-877-829-5500.
- IRS - Affiliate of national, statewide, or international parent nonprofit organization (charter)**
If your organization falls under a parent organization, attach copies of both of the following:
1. IRS letter showing your parent organization is a nonprofit 501(c) organization with a group ruling, and
2. the charter or letter from your parent organization recognizing your organization as a subordinate.

GAMBLING PREMISES INFORMATION

Name of premises where the gambling event will be conducted (for raffles, list the site where the drawing will take place): Cirrus Aircraft
Address (do not use P.O. box): 4515 Taylor Circle
City or Township: Duluth Zip: 55811 County: St. Louis
Date(s) of activity (for raffles, indicate the date of the drawing): Feb 6, 2016

Check each type of gambling activity that your organization will conduct:

- Bingo* Paddlewheels* Pull-Tabs* Tipboards*
 Raffle (total value of raffle prizes awarded for the calendar year: \$ TBD)

* **Gambling equipment** for bingo paper, paddlewheels, pull-tabs, and tipboards must be obtained from a distributor licensed by the Minnesota Gambling Control Board. EXCEPTION: Bingo hard cards and bingo number selection devices may be borrowed from another organization authorized to conduct bingo. To find a licensed distributor, go to www.mn.gov/gcb and click on **Distributors** under **LIST OF LICENSEES**, or call 651-539-1900.

LOCAL UNIT OF GOVERNMENT ACKNOWLEDGMENT (required before submitting application to the Minnesota Gambling Control Board)

<p style="text-align: center;">CITY APPROVAL for a gambling premises located within city limits</p> <p><input type="checkbox"/> The application is acknowledged with no waiting period.</p> <p><input type="checkbox"/> The application is acknowledged with a 30-day waiting period, and allows the Board to issue a permit after 30 days (60 days for a 1st class city).</p> <p><input type="checkbox"/> The application is denied.</p> <p>Print City Name: <u>Duluth</u></p> <p>Signature of City Personnel: <u>[Signature]</u></p> <p>Title: <u>Asst City Clerk</u> Date: <u>7/6/15</u></p> <div style="border: 1px solid black; padding: 5px; text-align: center; margin-top: 10px;"> <p>The city or county must sign before submitting application to the Gambling Control Board.</p> </div>	<p style="text-align: center;">COUNTY APPROVAL for a gambling premises located in a township</p> <p><input type="checkbox"/> The application is acknowledged with no waiting period.</p> <p><input type="checkbox"/> The application is acknowledged with a 30-day waiting period, and allows the Board to issue a permit after 30 days.</p> <p><input type="checkbox"/> The application is denied.</p> <p>Print County Name: _____</p> <p>Signature of County Personnel: _____</p> <p>Title: _____ Date: _____</p> <p>TOWNSHIP (if required by the county) On behalf of the township, I acknowledge that the organization is applying for exempted gambling activity within the township limits. (A township has no statutory authority to approve or deny an application, per Minn. Statutes, section 349.213.)</p> <p>Print Township Name: _____</p> <p>Signature of Township Officer: _____</p> <p>Title: _____ Date: _____</p>
--	---

CHIEF EXECUTIVE OFFICER'S SIGNATURE (required)

The information provided in this application is complete and accurate to the best of my knowledge. I acknowledge that the financial report will be completed and returned to the Board within 30 days of the event date.

Chief Executive Officer's Signature: [Signature] Date: 6/23/2015
(Signature must be CEO's signature; designee may not sign)

Print Name: Jennifer Hjelle

<p>REQUIREMENTS</p> <p>Complete a separate application for:</p> <ul style="list-style-type: none"> • all gambling conducted on two or more consecutive days, or • all gambling conducted on one day. <p>Only one application is required if one or more raffle drawings are conducted on the same day.</p> <p>Financial report to be completed within 30 days after the gambling activity is done: A financial report form will be mailed with your permit. Complete and return the financial report form to the Gambling Control Board.</p> <p>Your organization must keep all exempt records and reports for 3-1/2 years (Minn. Statutes, section 349.166, subd. 2(f)).</p>	<p>MAIL APPLICATION AND ATTACHMENTS</p> <p>Mail application with:</p> <p><input type="checkbox"/> a copy of your proof of nonprofit status, and</p> <p><input type="checkbox"/> application fee (non-refundable). If the application is postmarked or received 30 days or more before the event, the application fee is \$100; otherwise the fee is \$150. Make check payable to State of Minnesota.</p> <p>To: Gambling Control Board 1711 West County Road B, Suite 300 South Roseville, MN 55113</p> <p>Questions? Call the Licensing Section of the Gambling Control Board at 651-539-1900.</p>
--	--

<p>Data privacy notice: The information requested on this form (and any attachments) will be used by the Gambling Control Board (Board) to determine your organization's qualifications to be involved in lawful gambling activities in Minnesota. Your organization has the right to refuse to supply the information; however, if your organization refuses to supply this information, the Board may not be able to determine your organization's qualifications and, as a consequence, may refuse to issue a permit. If your organization supplies the information requested, the Board will be able to process the</p>	<p>application. Your organization's name and address will be public information when received by the Board. All other information provided will be private data about your organization until the Board issues the permit. When the Board issues the permit, all information provided will become public. If the Board does not issue a permit, all information provided remains private, with the exception of your organization's name and address which will remain public. Private data about your organization are available to Board members, Board staff whose work requires access to the information; Minnesota's Depart-</p>	<p>ment of Public Safety; Attorney General; Commissioners of Administration, Minnesota Management & Budget, and Revenue; Legislative Auditor, national and international gambling regulatory agencies; anyone pursuant to court order; other individuals and agencies specifically authorized by state or federal law to have access to the information; individuals and agencies for which law or legal order authorizes a new use or sharing of information after this notice was given; and anyone with your written consent.</p>
---	--	--



CITY OF DULUTH
CITY CLERK'S OFFICE
 330 City Hall | 411 West First Street
 Duluth, Minnesota 55802-1189
 Phone (218) 730-5500
 Fax (218) 730-5923

FOR OFFICE USE ONLY
 DATE 7/15/15
 LICENSE # 760177

GOVERNMENT DATA PRACTICES ACT - CLASSIFICATION WARNING: The data you supply on this form will be used to process the license you are applying for. You are not legally required to provide this data, but we will not be able to process the license without it. Some of the data will be classified as public data if and when the license is granted. Private financial information including a tax identification number and social security number are classified as private data and will be available to governmental personnel and other governmental agencies whose access is necessary to perform their official duties.

LICENSE APPLICATION

<u>LICENSE</u>	<u>FEE</u>	<u>TOTAL</u>
TEMPORARY ON SALE LIQUOR 1 st Day	\$298.00	\$
Each additional day ___ x \$148.00 =	\$	\$
LEVEL 1 INVESTIGATION FEE (one time)	\$ 31.00	\$

LICENSEE NAME/ADDRESS/PHONE NO.

Duluth Superior Pride
Bayfront Park
Duluth, MN 55802

TRADE NAME:

Duluth Superior Pride Festival

BUSINESS

PHONE: _____

MANAGER'S NAME & ADDRESS

Carolyn Reisberg
225 Osakis St.
Duluth, MN 55803

OWNER OF BUSINESS PREMISES:

PHONE: 218-349-6246

LICENSE/EVENT DATE: Sept. 5, 2015

I HEREBY STATE THAT ALL INFORMATION HERE IS TRUE AND CORRECT AND THAT I SHALL COMPLY WITH ALL PROVISION OF THE ORDINANCES OF THE CITY OF DULUTH AND LAWS OF THE STATE OF MINNESOTA AND THEIR AMENDMENTS.

[Signature]
 Signature of Applicant

Mailing Address:

Date of Application 7/15

License No. _____

TEMPORARY ON SALE LIQUOR (GRAPH)

*Owner: Duluth Superior GLBTAQI (d/b/a)*Trade Name: same
*Date of Event: Sept 5, 2011 Address Bayfront Park
*Name of Event: D/S pride festival *Time of Event: 11:00
*Security Personnel: Own security + DPD *Firm: Own security + DPD

DIAGRAM MUST SHOW:

- A. Area that will be used.
- B. Streets and intersections bordering the area.
- C. Where fencing surrounding the area will be located and what type of fencing will be used.
(Snow fence is preferred.)
- D. Where the bar will be located in the "serving area".
- E. Exits and entries to and from the "serving area".

Sketch location and dimensions of area to be occupied. Indicate north on diagram. (NORTH)

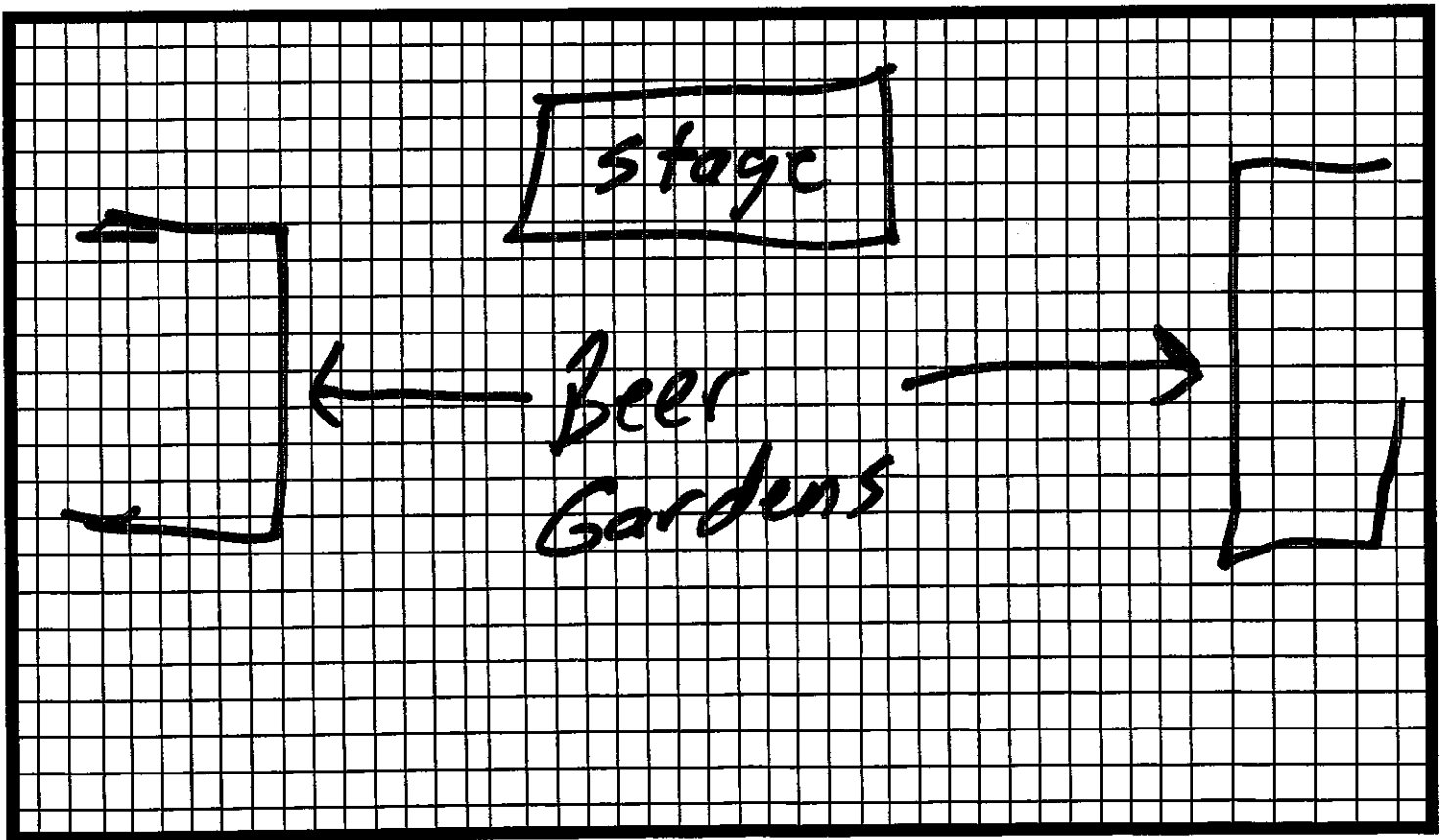

I hereby agree that I shall comply with all of the ordinances of the City of Duluth and laws of the State of MN and their amendments. I further agree to comply with any special restrictions which may be imposed by resolution of the Duluth City Council and not to allow any services, or consumption outside fo the approved "designated serving area" identified here.



CITY OF DULUTH
CITY CLERK'S OFFICE
 330 City Hall • 411 West First Street
 Duluth, Minnesota 55802-1189
 Phone (218) 730-6500
 Fax (218) 730-5923

FOR OFFICE USE ONLY
 DATE 7-23-2015
 LICENSE # 31

LICENSE APPLICATION

Type in your information by tabbing through the boxes below. Print, sign and submit all pages to the address above.

GOVERNMENT DATA PRACTICES ACT - CLASSIFICATION WARNING: The data you supply on this form will be used to process the license you are applying for. You are not legally required to provide this data, but we will not be able to process the license without it. Some of the data will be classified as public data if and when the license is granted. Private financial information including a tax identification number and social security number are classified as private data and will be available to governmental personnel and other governmental agencies whose access is necessary to perform their official duties.

LICENSE	FEE
TEMPORARY ON-SALE ^{Expansion} NON-INTOXICATING MALT LIQUOR (BEER) - 1st Day =	\$119.00 ^{\$358}
PLUS \$23.00 EACH ADDITIONAL DAY =	\$
TOTAL	\$ 119.00

~~Kenrite, Inc.~~
 Bulldog Pizza & Grill
 101 Mt. Royal Center
 Duluth MN 55803

TRADE NAME OR NAME OF EVENT:
 UMD Band Alumni reunion

BUSINESS PHONE NO. 218-728-3663

MANAGER'S NAME & ADDRESS:
 Ken Wright
 1901 E 6th street
 Duluth MN 55812

OWNER OF BUSINESS PREMISES:
 Ken & Sue Wright

EVENT LICENSE DATE(S):
 October 10, 2015

Rain Date? Yes No If yes, list date: _____
 Contact State Health Department at 723-4642 for application for beer and/or food.
 Security Personnel Questions? Call 730-5421
 Will dancing be allowed? Yes No
 If yes, contact the City Clerk's Office for dancing license application.

I HEREBY STATE THAT ALL INFORMATION HERE IS TRUE AND CORRECT AND THAT I SHALL COMPLY WITH ALL PROVISION OF THE ORDINANCES OF THE CITY OF DULUTH AND LAWS OF THE STATE OF MINNESOTA AND THEIR AMENDMENTS.

Ken Wright
 Signature of Applicant

MAILING ADDRESS:
101 Mt. Royal Circle
Duluth, MN
55803

EMAIL: kwwright@charter.net

Would you like notifications via email? YES NO

Date of Application 7/23/15
License No. 37

TEMPORARY EXPANSION OF LICENSED PREMISES (DIAGRAM)

Owner: Kenrite, Inc (d/b/a) Trade Name: Bulldog Pizza & Grill
Date of Event: October 10, 2015 Address: 101 Mt Royal Ctr
Name of Event: UMD Band Alumni reunion Time of Event: 4 PM
Security Personnel: _____ Firm: _____

DIAGRAM MUST SHOW:

- A. Area that will be used.
- B. Streets and intersections bordering the area.
- C. Where fencing surrounding the area will be located and what type of fencing will be used (snow fence is preferred).
- D. Where the bar will be located in the "serving area."
- E. Exits and entries to and from the "serving area."

Sketch location and dimensions of area to be occupied. Indicate north on diagram as "NORTH."

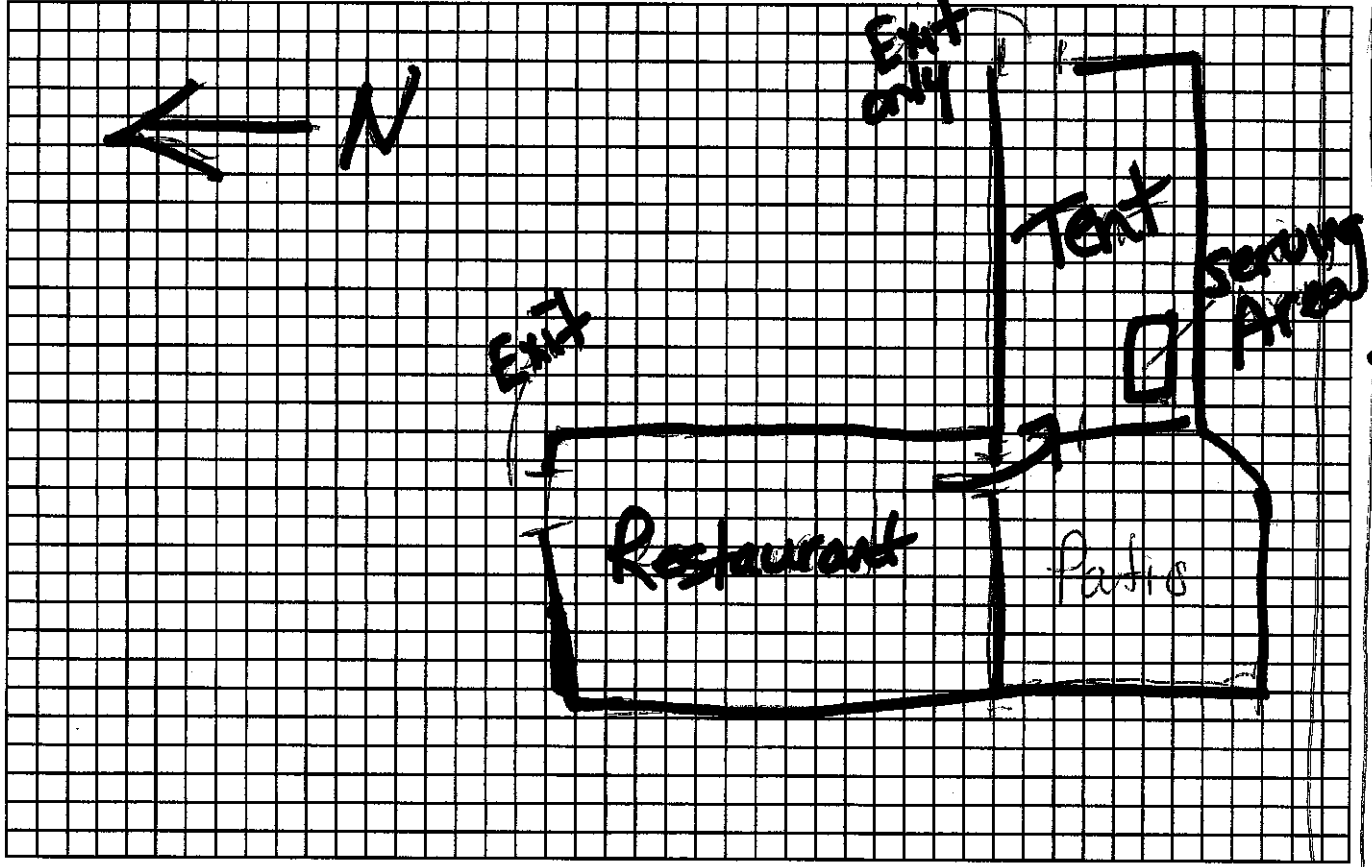

I hereby agree that I shall comply with all of the ordinances of the City of Duluth and laws of the State of Minnesota and their amendments. I further agree to comply with any special restrictions which may be imposed by resolution of the Duluth City Council and not to allow any services or consumption outside of the approved "designated serving area" identified here.

K. W. [Signature]
Signature of owner/authorized representative



License Renewal Batch Edit Listing

Sort by License Type, License Number

On Sale Liquor, Sunday, Dancing

Renewal Batch	on sale	Renewal Date	06/17/2015	Calculated Charges	\$390,574.00		
Renewals	85	Renewal Due Date	08/31/2015	Revised Charges	\$390,574.00		
License For/ Licensee	Selected	License Number	Licensee Number	License Effective Date	License Expiration Date	Calculated Charges	Revised Charges
License Type L-On Sale Liquor CANAL PARK BREWING CO CANAL PARK BREWING CO LLC	Yes	759767	330	09/01/2015	08/31/2016	4,339.00	4,339.00
				<i>Undesignated Balance Applied</i>			.00
FAMOUS DAVES BAYFRONT BBQ, INC.	Yes	759776	699	09/01/2015	08/31/2016	4,339.00	4,339.00
				<i>Undesignated Balance Applied</i>			.00
PIZZA LUCE PIZZA LUCE III, INC	Yes	759777	2055	09/01/2015	08/31/2016	5,731.00	5,731.00
				<i>Undesignated Balance Applied</i>			.00
SLC HERITAGE & ARTS CTR HISTORIC UNION DEPOT, INC	Yes	759780	1305	09/01/2015	08/31/2016	4,161.00	4,161.00
				<i>Undesignated Balance Applied</i>			.00
OSAKA SUSHI HIBACHI STKHS OSAKA DULUTH, INC.	Yes	759798	1992	09/01/2015	08/31/2016	4,339.00	4,339.00
				<i>Undesignated Balance Applied</i>			.00
MITCH`S BAR & GRILL MITCH`S, INC.	Yes	759801	1355	09/01/2015	08/31/2016	4,339.00	4,339.00
				<i>Undesignated Balance Applied</i>			.00
EDGEWATER RESORT & WTRPRK LAKE AIRE SVC CO DUL, LLC	Yes	759803	651	09/01/2015	08/31/2016	4,339.00	4,339.00
				<i>Undesignated Balance Applied</i>			.00
INN ON LAKE SUPERIOR ZENITH DULUTH, INC.	Yes	759804	999	09/01/2015	08/31/2016	4,339.00	4,339.00
				<i>Undesignated Balance Applied</i>			.00
SHOTZ BAR SHOTZ BAR, INC	Yes	759808	2259	09/01/2015	08/31/2016	4,339.00	4,339.00
				<i>Undesignated Balance Applied</i>			.00
HANABI JAPANESE CUISINE HANABI JAPANESE CUISN, CO	Yes	759812	876	09/01/2015	08/31/2016	4,339.00	4,339.00
				<i>Undesignated Balance Applied</i>			.00
SPIRIT MOUNTAINT RECREATION AREA AUTHORITY SPIRIT MOUNTAIN RECREATION AREA AUTHORITY	Yes	759825	2308	09/01/2015	08/31/2016	5,469.00	5,469.00
				<i>Undesignated Balance Applied</i>			.00
BEDROCK BAR CHASER'S OF DULUTH, INC	Yes	759828	229	09/01/2015	08/31/2016	4,339.00	4,339.00
				<i>Undesignated Balance Applied</i>			.00
OLD CHICAGO WADSWORTH OLD CHICAGO INC	Yes	759830	1975	09/01/2015	08/31/2016	4,339.00	4,339.00



License Renewal Batch Edit Listing

Sort by License Type, License Number

JADE FOUNTAIN LEE & TINA, INC A MN CORP	Yes	759834	1021	09/01/2015	08/31/2016	4,339.00	4,339.00	<i>Undesignated Balance Applied</i>	.00
ALPINE BAR & LOUNGE ALPINE BAR & LOUNGE, INC	Yes	759838	111	09/01/2015	08/31/2016	4,339.00	4,339.00	<i>Undesignated Balance Applied</i>	.00
COMFORT INN DULUTH LODGING, INC	Yes	759841	428	09/01/2015	08/31/2016	4,161.00	4,161.00	<i>Undesignated Balance Applied</i>	.00
LAKE AVENUE RESTAURNT/BAR THE LAKE EFFECT RESTAURANT INC	Yes	759842	1128	09/01/2015	08/31/2016	5,469.00	5,469.00	<i>Undesignated Balance Applied</i>	.00
BUFFALO WILD WINGS G & B BLAZIN WINGS, INC	Yes	759845	309	09/01/2015	08/31/2016	4,339.00	4,339.00	<i>Undesignated Balance Applied</i>	.00
BURRITO UNION JUST TAKE ACTION, INC	Yes	759846	312	09/01/2015	08/31/2016	4,339.00	4,339.00	<i>Undesignated Balance Applied</i>	.00
FITGERS BRWHS/RED STAR JUST TAKE ACTION, INC	Yes	759847	312	09/01/2015	08/31/2016	5,469.00	5,469.00	<i>Undesignated Balance Applied</i>	.00
TYCOONS ALEHOUSE & EATERY JUST TAKE ACTION, INC	Yes	759849	312	09/01/2015	08/31/2016	5,469.00	5,469.00	<i>Undesignated Balance Applied</i>	.00
FITGER'S 600 EAST SUPERIOR ST, INC	Yes	759852	713	09/01/2015	08/31/2016	4,161.00	4,161.00	<i>Undesignated Balance Applied</i>	.00
APPLEBEES GRILL/BAR APPLE MINNESOTA, LLC	Yes	759853	139	09/01/2015	08/31/2016	4,339.00	4,339.00	<i>Undesignated Balance Applied</i>	.00
CARMODY IRISH PUB HIPPO DOWN THE STREET LLC	Yes	759855	355	09/01/2015	08/31/2016	4,339.00	4,339.00	<i>Undesignated Balance Applied</i>	.00
PORTER/SNEAKER/GREENERY LYRIC BLOCK DEVELOPMENT	Yes	759857	953	09/01/2015	08/31/2016	5,469.00	5,469.00	<i>Undesignated Balance Applied</i>	.00
G B SCHNEIDER CO SCHNEIDER`S KITCHEN, INC	Yes	759858	761	09/01/2015	08/31/2016	4,339.00	4,339.00	<i>Undesignated Balance Applied</i>	.00
REEF BAR LEMON'S REEF, INC	Yes	759871	2120	09/01/2015	08/31/2016	5,469.00	5,469.00	<i>Undesignated Balance Applied</i>	.00
GRIZZLY`S GRILL & SALOON RANGE RESTAURANTS, LLC	Yes	759873	858	09/01/2015	08/31/2016	4,339.00	4,339.00	<i>Undesignated Balance Applied</i>	.00



License Renewal Batch Edit Listing

Sort by License Type, License Number

GRIZZLY'S WOOD FIRED GRILL RANGE RESTAURANTS, LLC	Yes	759874	858	09/01/2015	08/31/2016	4,339.00	4,339.00
						<i>Undesignated Balance Applied</i>	.00
CLUB SARATOGA PDL OF DULUTH, INC	Yes	759880	419	09/01/2015	08/31/2016	4,339.00	4,339.00
						<i>Undesignated Balance Applied</i>	.00
GREAT LAKES AQUARIUM LAKE SUPERIOR CENTER AUTHORITY	Yes	759881	848	09/01/2015	08/31/2016	4,339.00	4,339.00
						<i>Undesignated Balance Applied</i>	.00
BERGEY'S BERGEY'S LLC	Yes	759882	244	09/01/2015	08/31/2016	4,339.00	4,339.00
						<i>Undesignated Balance Applied</i>	.00
REX MISUL, INC	Yes	759883	2130	09/01/2015	08/31/2016	5,469.00	5,469.00
						<i>Undesignated Balance Applied</i>	.00
INCLINESTATION/SPOT SPORTS BAR & GRILL KEGLERS, INC	Yes	759885	994	09/01/2015	08/31/2016	4,339.00	4,339.00
						<i>Undesignated Balance Applied</i>	.00
BELLISIOS ITALIAN RSTRNT GRANDMA'S SPORTS BAR/GRILL, INC.	Yes	759891	236	09/01/2015	08/31/2016	4,339.00	4,339.00
						<i>Undesignated Balance Applied</i>	.00
LITTLE ANGIE'S CANTINA GRANDMA'S ANGIE'S, INC	Yes	759892	1215	09/01/2015	08/31/2016	4,339.00	4,339.00
						<i>Undesignated Balance Applied</i>	.00
GRANDMA'S SALOON/GRILL GRANDMA'S/MILLER HILL INC	Yes	759894	836	09/01/2015	08/31/2016	4,339.00	4,339.00
						<i>Undesignated Balance Applied</i>	.00
GRANDMA'S SPORT GARDEN GRANDMA'S SPORTS BAR/GRILL, INC.	Yes	759895	236	09/01/2015	08/31/2016	5,469.00	5,469.00
						<i>Undesignated Balance Applied</i>	.00
GRANDMA'S SALOON/GRILL GRANDMA'S, INC	Yes	759897	829	09/01/2015	08/31/2016	4,339.00	4,339.00
						<i>Undesignated Balance Applied</i>	.00
TEATRO/ZINEMA/ZA CAFE ZEITGEIST ARTS, LLC	Yes	759899	2407	09/01/2015	08/31/2016	4,339.00	4,339.00
						<i>Undesignated Balance Applied</i>	.00
RUSTIC BAR RUSTIC BAR, INC	Yes	759900	2172	09/01/2015	08/31/2016	4,339.00	4,339.00
						<i>Undesignated Balance Applied</i>	.00
COUNTRY LANES NORTH COUNTRY LANES NORTH, INC	Yes	759902	458	09/01/2015	08/31/2016	4,339.00	4,339.00
						<i>Undesignated Balance Applied</i>	.00
CLYDE IRON WORKS REST/BAR CLYDE IND PARK, INC.	Yes	759904	421	09/01/2015	08/31/2016	5,469.00	5,469.00
						<i>Undesignated Balance Applied</i>	.00
COPASETIC LOUNGE J & J MILLER, INC	Yes	759908	446	09/01/2015	08/31/2016	4,339.00	4,339.00



License Renewal Batch Edit Listing

Sort by License Type, License Number

GOPHER RESTAURANT/LOUNGE S & D ENTERPRISES, INC.	Yes	759912	811	09/01/2015	08/31/2016	4,339.00	4,339.00	<i>Undesignated Balance Applied</i>	.00
ROSCOE`S PIONEER BAR ROSSBERG, INC	Yes	759914	2159	09/01/2015	08/31/2016	4,339.00	4,339.00	<i>Undesignated Balance Applied</i>	.00
CURLY`S BAR CURLY`S BAR, INC	Yes	759916	476	09/01/2015	08/31/2016	4,339.00	4,339.00	<i>Undesignated Balance Applied</i>	.00
TEXAS ROADHOUSE TEXAS ROADHOUSE HOLDINGS LLC	Yes	759922	2416	09/01/2015	08/31/2016	4,339.00	4,339.00	<i>Undesignated Balance Applied</i>	.00
BLACKWOODS ON THE LAKE BLACKWOODS ON LAKE, INC	Yes	759923	259	09/01/2015	08/31/2016	4,339.00	4,339.00	<i>Undesignated Balance Applied</i>	.00
BLACK WATER AT GREYSOLON BLACK WATER AT GREYSOLON, LLC	Yes	759924	260	09/01/2015	08/31/2016	4,339.00	4,339.00	<i>Undesignated Balance Applied</i>	.00
D E C C DULUTH ENTERTAINMENT CONVENTION CENTER	Yes	759927	497	09/01/2015	08/31/2016	5,469.00	5,469.00	<i>Undesignated Balance Applied</i>	.00
PICKWICK RESTAURANT & BAR THE WICK, INC	Yes	759930	2036	09/01/2015	08/31/2016	4,339.00	4,339.00	<i>Undesignated Balance Applied</i>	.00
VALENTINI`S VICINO LAGO ROSE GARDEN ENT, LLC	Yes	759931	2542	09/01/2015	08/31/2016	4,339.00	4,339.00	<i>Undesignated Balance Applied</i>	.00
T-BONZ BAR T-BONZ ENTERPRIZES, INC	Yes	759932	2386	09/01/2015	08/31/2016	4,339.00	4,339.00	<i>Undesignated Balance Applied</i>	.00
ROUND-UP BAR & GRILL SHEMPCO, INC.	Yes	759933	2166	09/01/2015	08/31/2016	4,339.00	4,339.00	<i>Undesignated Balance Applied</i>	.00
PLAYERS SPORTS BAR PLAYER`S GRANDSTAND, INC	Yes	759934	2057	09/01/2015	08/31/2016	4,339.00	4,339.00	<i>Undesignated Balance Applied</i>	.00
MR. D`S SPIRIT VALLEY D & D ENTERPRISES OF CLOQUET INC	Yes	759937	1385	09/01/2015	08/31/2016	5,469.00	5,469.00	<i>Undesignated Balance Applied</i>	.00
SHERATON DULUTH HOTEL THE DULUTH GRAND, LLC	Yes	759945	2254	09/01/2015	08/31/2016	4,339.00	4,339.00	<i>Undesignated Balance Applied</i>	.00
MEXICO LINDO JOEL`S, LLC	Yes	759955	1319	09/01/2015	08/31/2016	4,339.00	4,339.00		



License Renewal Batch Edit Listing

Sort by License Type, License Number

TIMBER LODGE STEAKHOUSE TAHER RESTAURANT ACQUISIT	Yes	759957	2465	09/01/2015	08/31/2016	4,339.00	4,339.00	<i>Undesignated Balance Applied</i>	.00
								<i>Undesignated Balance Applied</i>	.00
SPURS ON 1ST THE DUKES PARTNERS, LLC	Yes	759958	2318	09/01/2015	08/31/2016	5,291.00	5,291.00	<i>Undesignated Balance Applied</i>	.00
								<i>Undesignated Balance Applied</i>	.00
VA BENE VA BENE CAFE, INC.	Yes	759962	2541	09/01/2015	08/31/2016	4,339.00	4,339.00	<i>Undesignated Balance Applied</i>	.00
								<i>Undesignated Balance Applied</i>	.00
KOM ON INN JMMP ENTERPRISES, LLC	Yes	759963	1109	09/01/2015	08/31/2016	4,339.00	4,339.00	<i>Undesignated Balance Applied</i>	.00
								<i>Undesignated Balance Applied</i>	.00
DUBH LINN IRISH BREW PUB DUBH LINN, INC.	Yes	759964	563	09/01/2015	08/31/2016	4,339.00	4,339.00	<i>Undesignated Balance Applied</i>	.00
								<i>Undesignated Balance Applied</i>	.00
ACES ON FIRST HOSPITALITY ASSOCIATES OF DULUTH, LLC	Yes	759965	66	09/01/2015	08/31/2016	5,291.00	5,291.00	<i>Undesignated Balance Applied</i>	.00
								<i>Undesignated Balance Applied</i>	.00
OLIVE GARDEN GMRI, INC	Yes	759967	1980	09/01/2015	08/31/2016	4,339.00	4,339.00	<i>Undesignated Balance Applied</i>	.00
								<i>Undesignated Balance Applied</i>	.00
MIDI RESTAURANT MIDI ENTERPRISES, INC	Yes	759969	1322	09/01/2015	08/31/2016	4,339.00	4,339.00	<i>Undesignated Balance Applied</i>	.00
								<i>Undesignated Balance Applied</i>	.00
R T QUINLAN`S SALOON SILVER HAMMER, INC	Yes	759970	1352	09/01/2015	08/31/2016	4,339.00	4,339.00	<i>Undesignated Balance Applied</i>	.00
								<i>Undesignated Balance Applied</i>	.00
FLAME NIGHTCLUB DULUTH FLAME NIGHTCLUB, INC.	Yes	759972	726	09/01/2015	08/31/2016	5,469.00	5,469.00	<i>Undesignated Balance Applied</i>	.00
								<i>Undesignated Balance Applied</i>	.00
UNDERGROUND DULUTH PLAYHOUSE, INC.	Yes	760134	611	09/01/2015	08/31/2016	4,161.00	4,161.00	<i>Undesignated Balance Applied</i>	.00
								<i>Undesignated Balance Applied</i>	.00
GRANDMA'S HOSPITALITY #1 GRANDMA'S SPORTS BAR/GRILL, INC.	Yes	760136	236	09/01/2015	08/31/2016	4,339.00	4,339.00	<i>Undesignated Balance Applied</i>	.00
								<i>Undesignated Balance Applied</i>	.00
AT SARA'S TABLE CHESTER CREEK CAFE AT SARA`S TABLE CHESTER CREEK CAFE, LLC	Yes	760167	384	09/01/2015	08/31/2016	4,339.00	4,339.00	<i>Undesignated Balance Applied</i>	.00
								<i>Undesignated Balance Applied</i>	.00
Radisson Hotel Duluth Harborview WAYZATA DULUTH HOSPITALTY ASSOCIATES, LLC	Yes	760168	4600	09/01/2015	08/31/2016	5,469.00	5,469.00	<i>Undesignated Balance Applied</i>	.00
								<i>Undesignated Balance Applied</i>	.00



License Renewal Batch Edit Listing

Sort by License Type, License Number

ARROWHEAD TAP HOUSE OAKWELLS COMMUTER RAIL, LLC	Yes	760172	8521	09/01/2015	08/31/2016	4,339.00	4,339.00
				<i>Undesignated Balance Applied</i>			.00
CHIPOTLE MEXICAN GRILL CHIPOTLE MEXICAN GRILL OF COLORADO, LLC	Yes	760175	8762	09/01/2015	08/31/2016	4,339.00	4,339.00
				<i>Undesignated Balance Applied</i>			.00
TAVERN ON THE HILL BLACK AT BLUE, LLC	Yes	760177	8766	09/01/2015	08/31/2016	5,731.00	5,731.00
				<i>Undesignated Balance Applied</i>			.00
THE RED HERRING LOUNGE RED HERRING, LLC	Yes	760179	8782	09/01/2015	08/31/2016	5,731.00	5,731.00
				<i>Undesignated Balance Applied</i>			.00
ENDION STATION PUBLIC HOUSE JUST TAKE ACTION, INC	Yes	760180	312	09/01/2015	08/31/2016	4,339.00	4,339.00
				<i>Undesignated Balance Applied</i>			.00
AZTECA'S MEXICAN GRILL AZTECA'S MEXICAN GRILL, INC.	Yes	760181	8965	09/01/2015	08/31/2016	4,339.00	4,339.00
				<i>Undesignated Balance Applied</i>			.00
THE BREAK ROOM THE GREENS DULUTH, INC.	Yes	760183	5263	09/01/2015	08/31/2016	5,469.00	5,469.00
				<i>Undesignated Balance Applied</i>			.00
ARAMARK EDUCATIONAL SERVICES ARAMARK EDUCATIONAL SERVICES, LLC	Yes	760184	9480	09/01/2015	08/31/2016	4,910.00	4,910.00
				<i>Undesignated Balance Applied</i>			.00
SIR BENEDICT'S TAVERN ON THE LAKE SIR BENEDICT'S IV, INC.	Yes	760185	9564	09/01/2015	08/31/2016	4,339.00	4,339.00
				<i>Undesignated Balance Applied</i>			.00
ENGER PARK GOLF COURSE ENGER PARK GOLF MANAGEMENT, LLC	Yes	760186	9632	09/01/2015	08/31/2016	4,339.00	4,339.00
				<i>Undesignated Balance Applied</i>			.00
JADE FOUNTAIN JADE FOUNTAIN, LLC	Yes	760187	9762	09/01/2015	08/31/2016	4,339.00	4,339.00
				<i>Undesignated Balance Applied</i>			.00
CLOUD 9 ASIAN BISTRO COOL ASIAN BISTRO DULUTH, INC.	Yes	760188	9885	09/01/2015	08/31/2016	4,339.00	4,339.00
				<i>Undesignated Balance Applied</i>			.00
Total for License Type L-On Sale Liquor						390,574.00	



License Renewal Batch Edit Listing

Sort by License Type, License Number

Theater

Renewal Batch	theater	Renewal Date	06/10/2015	Calculated Charges	\$636.00		
		Renewal Due Date	08/31/2015	Revised Charges	\$636.00		
Renewals	2			Undesignated Balance Applied	\$0.00		
License For/ Licensee	Selected	License Number	Licensee Number	License Effective Date	License Expiration Date	Calculated Charges	Revised Charges
License Type L-Theater							
DULUTH CINEMA FAMILY ENTERTAINMENT, LLC	Yes	759346	590	09/01/2015	08/31/2016	318.00	318.00
				<i>Undesignated Balance Applied</i>			.00
DULUTH PLAYHOUSE DULUTH PLAYHOUSE, INC.	Yes	759348	611	09/01/2015	08/31/2016	318.00	318.00
				<i>Undesignated Balance Applied</i>			.00
Total for License Type L-Theater						636.00	



License Renewal Batch Edit Listing

Wine license

Sort by License Type, License Number

Renewal Batch	ON SALE WINE	Renewal Date	06/10/2015	Calculated Charges	\$13,380.00		
		Renewal Due Date	08/31/2015	Revised Charges	\$13,380.00		
Renewals	16			Undesignated Balance Applied	\$0.00		
License For/ Licensee	Selected	License Number	Licensee Number	License Effective Date	License Expiration Date	Calculated Charges	Revised Charges
License Type L-On Sale Wine NOODLES & COMPANY THE NOODLE SHOP CO.	Yes	759420	1915	09/01/2015	08/31/2016	892.00	892.00
				<i>Undesignated Balance Applied</i>			.00
CHINA CAFE CHINA CAFE OF DULUTH, INC	Yes	759771	393	09/01/2015	08/31/2016	892.00	892.00
				<i>Undesignated Balance Applied</i>			.00
7 WEST TAP HOUSE UP NORTH TAPS, LLC	Yes	759787	21	09/01/2015	08/31/2016	892.00	892.00
				<i>Undesignated Balance Applied</i>			.00
TASTE OF SAIGON TASTE OF SAIGON, INC	Yes	759814	2405	09/01/2015	08/31/2016	892.00	892.00
				<i>Undesignated Balance Applied</i>			.00
DULUTH HUSKIES R P K BASEBALL, INC.	Yes	759820	599	09/01/2015	08/31/2016	892.00	892.00
				<i>Undesignated Balance Applied</i>			.00
VITTA PIZZA VITTA PIZZA, INC.	Yes	759833	2562	09/01/2015	08/31/2016	892.00	892.00
				<i>Undesignated Balance Applied</i>			.00
BULLDOG PIZZA & GRILL KENRITE, INC	Yes	759868	310	09/01/2015	08/31/2016	892.00	892.00
				<i>Undesignated Balance Applied</i>			.00
DULUTH INDIA PALACE JCEBAL COMPANY	Yes	759876	601	09/01/2015	08/31/2016	892.00	892.00
				<i>Undesignated Balance Applied</i>			.00
TAPPA KEG INN TAPPA KEG INN, INC	Yes	759905	2399	09/01/2015	08/31/2016	892.00	892.00
				<i>Undesignated Balance Applied</i>			.00
BEANER`S CENTRAL BEANER`S CENTRAL INC	Yes	759911	226	09/01/2015	08/31/2016	892.00	892.00
				<i>Undesignated Balance Applied</i>			.00
AMAZING GRACE BAKERY & CAFE STEWART-ZAUN, INC.	Yes	759998	2525	09/01/2015	08/31/2016	892.00	892.00
				<i>Undesignated Balance Applied</i>			.00
SAMMY'S PIZZA & RESTAURANT TRM4, INC.	Yes	759999	2483	09/01/2015	08/31/2016	892.00	892.00
				<i>Undesignated Balance Applied</i>			.00
TOASTY'S BIG LAKE, LLC	Yes	760001	8409	09/01/2015	08/31/2016	892.00	892.00
				<i>Undesignated Balance Applied</i>			.00



License Renewal Batch Edit Listing

Sort by License Type, License Number

IRON MUG COFFEE HOUSE IRON MUG COFFEE HOUSE, LLC	Yes	760004	9229	09/01/2015	08/31/2016	892.00	892.00
						<i>Undesignated Balance Applied</i>	.00
SALA THAI RESTAURANT LOY KRATHONG, INC	Yes	760005	2184	09/01/2015	08/31/2016		
						<i>Undesignated Balance Applied</i>	.00
PIZZA HUT MUY! PIZZA MINNESOTA, LLC	Yes	760006	9871	09/01/2015	08/31/2016	892.00	892.00
						<i>Undesignated Balance Applied</i>	.00
Total for License Type L-On Sale Wine						13,380.00	



License Renewal Batch Edit Listing

B+B Wine Licenses

Sort by License Type, License Number

Renewal Batch	08312015	Renewal Date	06/10/2015	Calculated Charges	\$890.00		
		Renewal Due Date	08/31/2015	Revised Charges	\$890.00		
Renewals	2			Undesignated Balance Applied	\$0.00		
License For/ Licensee	Selected	License Number	Licensee Number	License Effective Date	License Expiration Date	Calculated Charges	Revised Charges
License Type L-On Sale Wine B&B							
A G THOMSON HOUSE	Yes	759763	43	09/01/2015	08/31/2016	445.00	445.00
AG THOMSON HOUSE HIST B&B							
				<i>Undesignated Balance Applied</i>			.00
FIRELIGHT INN	Yes	759906	711	09/01/2015	08/31/2016	445.00	445.00
FIRELIGHT INN ON OREGON CREEK INC							
				<i>Undesignated Balance Applied</i>			.00
Total for License Type L-On Sale Wine B&B						890.00	



License Renewal Batch Edit Listing

Sort by License Type, License Number

Off Sale Liquor

Renewal Batch	OFF SALE LIQUOR	Renewal Date	06/10/2015	Calculated Charges	\$28,400.00		
Renewals	18	Renewal Due Date	08/31/2015	Revised Charges	\$28,400.00		
License For/ Licensee	Selected	License Number	Licensee Number	License Effective Date	License Expiration Date	Calculated Charges	Revised Charges
License Type L-Off Sale Liquor							
WOODLAND LIQUORS WOODLAND LIQUORS, INC	Yes	759764	2631	09/01/2015	08/31/2016	1,500.00	1,500.00
				<i>Undesignated Balance Applied</i>			.00
LAKE SUPERIOR BOTTLE SHOP DAJER, INC	Yes	759781	1136	09/01/2015	08/31/2016	1,500.00	1,500.00
				<i>Undesignated Balance Applied</i>			.00
SUPER ONE LIQUOR SUPER ONE LIQUOR, LLC	Yes	759783	2363	09/01/2015	08/31/2016	1,500.00	1,500.00
				<i>Undesignated Balance Applied</i>			.00
GEORGE`S LIQUOR GEORGE`S LIQUOR, INC.	Yes	759819	780	09/01/2015	08/31/2016	1,500.00	1,500.00
				<i>Undesignated Balance Applied</i>			.00
BIG BOTTLE SHOP MALLOW ENTERPRISES, INC	Yes	759821	249	09/01/2015	08/31/2016	1,500.00	1,500.00
				<i>Undesignated Balance Applied</i>			.00
UNIVERSITY LIQUOR ROTO OF DULUTH, INC.	Yes	759822	2528	09/01/2015	08/31/2016	1,500.00	1,500.00
				<i>Undesignated Balance Applied</i>			.00
LAKE AIRE BOTTLE SHOPPE D A FITZPATRICK, INC	Yes	759824	1124	09/01/2015	08/31/2016	1,500.00	1,500.00
				<i>Undesignated Balance Applied</i>			.00
GARY LIQUORS J & J JAUSS, INC.	Yes	759826	770	09/01/2015	08/31/2016	1,500.00	1,500.00
				<i>Undesignated Balance Applied</i>			.00
FITGER'S WINE CELLARS FITGER'S WINE CELLARS LLC	Yes	759851	722	09/01/2015	08/31/2016	1,500.00	1,500.00
				<i>Undesignated Balance Applied</i>			.00
SHANTY BOTTLE SHOP RED CARPET BOTTLE HSE INC	Yes	759859	2249	09/01/2015	08/31/2016	1,500.00	1,500.00
				<i>Undesignated Balance Applied</i>			.00
WAREHOUSE LIQUOR STORE CITY WINE & LIQUOR STORE, INC.	Yes	759861	2583	09/01/2015	08/31/2016	1,500.00	1,500.00
				<i>Undesignated Balance Applied</i>			.00
CANAL PARK LIQUOR CANAL PARK LIQUOR, LLC	Yes	759889	336	09/01/2015	08/31/2016	1,500.00	1,500.00
				<i>Undesignated Balance Applied</i>			.00
LOISELLE LIQUOR STORE LOISELLE`S, INC.	Yes	759903	1232	09/01/2015	08/31/2016	1,500.00	1,500.00
				<i>Undesignated Balance Applied</i>			.00



License Renewal Batch Edit Listing

Sort by License Type, License Number

WILD WEST LIQUOR JNC LIQUORS INC.	Yes	759928	2615	09/01/2015	08/31/2016	1,500.00	1,500.00
				<i>Undesignated Balance Applied</i>			.00
MT ROYAL BOTTLE SHOPPE MT ROYAL BOTTLE SHOP, INC	Yes	759949	1394	09/01/2015	08/31/2016	1,500.00	1,500.00
				<i>Undesignated Balance Applied</i>			.00
PIEDMONT LIQUOR BROAD EAVES, LLC	Yes	759967	2039	09/01/2015	08/31/2016	1,500.00	1,500.00
				<i>Undesignated Balance Applied</i>			.00
LAST CHANCE LIQUOR LAST CHANCE OF DULUTH, INC. (2)	Yes	759968	2514	09/01/2015	08/31/2016	1,400.00	1,400.00
				<i>Undesignated Balance Applied</i>			.00
CASH WISE LIQUOR COBORN'S, INC	Yes	759969	366	09/01/2015	08/31/2016	1,500.00	1,500.00
				<i>Undesignated Balance Applied</i>			.00
27 LIQUORS, LLC 27 LIQUORS, LLC	Yes	759971	9698	09/01/2015	08/31/2016	1,500.00	1,500.00
				<i>Undesignated Balance Applied</i>			.00
Total for License Type L-Off Sale Liquor						28,400.00	



License Renewal Batch Edit Listing

Sort by License Type, License Number

Club Licenses

Renewal Batch	on sale club	Renewal Date	06/10/2015	Calculated Charges	\$5,984.00		
Renewals	9	Renewal Due Date	08/31/2015	Revised Charges	\$5,984.00		
License For/Licensee	Selected	License Number	Licensee Number	License Effective Date	License Expiration Date	Calculated Charges	Revised Charges
License Type L-Club							
RIDGEVIEW COUNTRY CLUB	Yes	759778	2135	09/01/2015	08/31/2016	676.00	676.00
RIDGEVIEW COUNTRY CLUB				<i>Undesignated Balance Applied</i>			.00
WEST DULUTH AM LEGION	Yes	759799	2593	09/01/2015	08/31/2016	976.00	976.00
AMERICAN LEGION POST 71				<i>Undesignated Balance Applied</i>			.00
DULUTH CURLING CLUB	Yes	759815	593	09/01/2015	08/31/2016	676.00	676.00
DULUTH CURLING CLUB INC				<i>Undesignated Balance Applied</i>			.00
KITCHI GAMMI CLUB	Yes	759818	1098	09/01/2015	08/31/2016	826.00	826.00
KITCHI GAMMI CLUB, INC				<i>Undesignated Balance Applied</i>			.00
ALL AMERICAN CLUB	Yes	759840	95	09/01/2015	08/31/2016	476.00	476.00
ALL AMERICAN CLUB				<i>Undesignated Balance Applied</i>			.00
NORTHLAND COUNTRY CLUB	Yes	759864	1405	09/01/2015	08/31/2016	676.00	676.00
NORTHLAND COUNTRY CLUB				<i>Undesignated Balance Applied</i>			.00
VFW POST #137	Yes	759935	2550	09/01/2015	08/31/2016	826.00	826.00
VFW MCCONNELL-MODEEN POST				<i>Undesignated Balance Applied</i>			.00
ELKS CLUB	Yes	759936	665	09/01/2015	08/31/2016	176.00	176.00
ELKS, BPO, DUL LODGE 133				<i>Undesignated Balance Applied</i>			.00
DULUTH OWL'S CLUB	Yes	759937	9561	09/01/2015	08/31/2016	676.00	676.00
FRATERNAL BUILDING ASSOCIATION				<i>Undesignated Balance Applied</i>			.00
Total for License Type L-Club						5,984.00	



License Renewal Batch Edit Listing

Sort by License Type, License Number

on and off sale Brewery

Renewal Batch	off sale brew	Renewal Date	06/10/2015	Calculated Charges	\$1,065.00		
Renewals	5	Renewal Due Date	08/31/2015	Revised Charges	\$1,065.00		
License For/ Licensee	Selected	License Number	Licensee Number	License Effective Date	License Expiration Date	Calculated Charges	Revised Charges
License Type L-Off Sale Brewery Malt Liquor							
CANAL PARK BREWING CO	Yes	759797	330	09/01/2015	08/31/2016	213.00	213.00
CANAL PARK BREWING CO LLC							
				<i>Undesignated Balance Applied</i>			.00
FITGERS BRWHS/RED STAR	Yes	759847	312	09/01/2015	08/31/2016	213.00	213.00
JUST TAKE ACTION, INC							
				<i>Undesignated Balance Applied</i>			.00
CARMODY IRISH PUB	Yes	759855	355	09/01/2015	08/31/2016	213.00	213.00
HIPPO DOWN THE STREET LLC							
				<i>Undesignated Balance Applied</i>			.00
LAKE SUPERIOR BREWING CO	Yes	759942	1139	09/01/2015	08/31/2016	213.00	213.00
LAKE SUPERIOR BREWING COMPANY, LLC							
				<i>Undesignated Balance Applied</i>			.00
BENT PADDLE BREWING CO.	Yes	760129	242	09/01/2015	08/31/2016	213.00	213.00
BENT PADDLE BREWING CO.							
				<i>Undesignated Balance Applied</i>			.00
<i>on and off Sunday</i>							
<i>on and off Sunday</i>							
Total for License Type L-Off Sale Brewery Malt Liquor						1,065.00	

